

2017年8月28日 13時～16時
13:00-16:00, August 28, 2017

[C 計画・設計・論文]
[C Planning/Design/Essay]

C-3 計画・設計
(専攻分野：都市計画)
C-3 Planning and Design
(Major Field of Study: Urban Planning)

受験番号

Examination I. D.

- (1) すべての答案用紙の所定の欄に、受験番号を記入しなさい。氏名を記入してはならない。
Write your examination I. D. on all the answer sheets.
Do not write your name.
- (2) 問題冊子に受験番号を記入しなさい。
Write your examination I. D. on this sheet.
- (3) 専攻分野として「都市計画」を希望するものは、C-3、C-4のいずれか1科目を解答しなさい。
If your major field of study is “Urban Planning,” then answer either C-3 or C-4.

C – 3 Planning and Design

Propose a development concept for Site X (approximately 29ha) and a development plan for Block 2 (approximately 3.9ha) after reading the following sentences and Figure 1 (図 1) .

1. About the site and the surroundings

- City Y is an ordinance-designated City (政令指定都市) with the growing population currently counts approximately 2.3 million. Site X is a former industrial site in a mixed residential/industrial area located approximately 7 km south of the central station of City Y. Site X will be redeveloped as a mixed residential/commercial urban area.
- North of Site X is a low- to mid-rise mixed residential/industrial urban area.
- To the east of Site X, there is a 6 lanes Arterial Road A partly covered by Structure B, which is an elevated urban expressway.
- In Site X, Road C, Road D and Road E are constructed.
- In the center of Site X is Track J on the embankment 4m above the ground level. Track J is an abandoned freight train track. Road E crosses Track J by an under path. Because of structural reasons, a part of Road E lower than the ground level has a wider width.
- Site X is divided into six blocks as Blocks 1 to 6 by Road C, D, E and Track J.
- In Block 1, development of a large-scale shopping center with parking lots is decided but its site plan for buildings and open space has not been prepared. The shopping center will contain a number of retails including women's and men's clothing shops, lifestyle goods, grocery stores, restaurants, food courts, and services.
- In Blocks 2, 3, 4 and 5, a residential-oriented development will be planned which is expected to be a model for a hyper-aged and low-carbon society in City Y.
- Block 6 will be developed as a waterfront park.
- There is a Subway Station F to the south of Site X along the west side of Arterial Road A. Arterial Road A has a pedestrian space with a sufficient width.
- To the west of Site X is Canal G and to the south of Site X is Canal H, which is a tributary of Canal G. There is an ongoing effort to improve the water quality of these canals. Park I was developed by covering a part of Canal H.
- Around Site X, there is an Elementary School K and a Junior High School L.

Children living in Site X will commute to these schools.

- Summer in City Y is hot and humid, where the daytime high sometime exceeds 35°C. On the other hand, winter in City Y is cold but snow is limited, so there is no need of considering snow cover in the development concept and the development plan.

2. Development concept for Site X

《Planning requirements》

- In Block 1, a large-scale shopping center, 4 stories with the total floor area of approximately 100,000m², and its parking lots should be planned. Retail spaces of approximately 55,000 m² that accommodate around 200 shops and parking lots for approximately 2,500 cars should be included. Parking lots can be partially provided in a multi-story parking garage.
- Blocks 2 to 5 should accommodate residential-oriented developments with the maximum floor area ratio of 200%. Facilities necessary for residents, e.g. small shops, community centers, playgrounds for infants and elementary school children, bicycle parking spaces, and garbage collection spaces, should be provided.
- Abundant car parking lots with a 100% coverage of households in Blocks 2 to 5 should be provided.
- Block 6 is a waterfront park, but restaurants, cafes and parking lots for park users may be located inside the park.
- More than 25% of Site X should be seized of green open spaces.

《Required planning documents》

By using 「解答用紙 1 : 地区 X の開発構想 (図面) (Answer Sheet 1: Development Concept for Site X (Map))」 and 「解答用紙 2 : 地区 X の開発構想・街区 2 の開発計画 (文章) (Answer Sheet 2: Development Concept for Site X and Development Plan for Block 2 (Texts))」, propose a development concept for Site X, which includes the following items, with a 1/2500 map and texts. If necessary, you may illustrate diagrams and sketches with the texts.

- (1) Development concept for Site X as a whole and for each block
- (2) Land use planning polices (use, building form, building volume and building arrangement, arrangement of various facilities, etc.)
- (3) Transportation policies (flows of automobiles, bicycles and pedestrians, specification of streets and ways, etc.)

- (4) Open space development policies (arrangements of parks, green and open spaces, etc.)
- (5) Policy for the utilization of Track J

3. Development plan for Block 2

《Planning requirements》

- Provide approximately 250 housing units for families and approximately 150 housing units for singles or couples.
- Abundant car parking lots with a 100% coverage of households should be provided. Structure of parking lots can be surface, multi-story or integrated with buildings.
- Provide a neighborhood park with the area of more than 2500m².
- Provide small shops, a community center, playgrounds for infants and elementary school children, bicycle parking spaces, garbage collection spaces, etc. that are necessary for the residents.

《Required planning documents》

Using 「解答用紙 2 : 地区 X の開発構想・街区 2 の開発計画 (文章) (Answer Sheet 2: Development Concept for Site X and Development Plan for Block 2 (Texts))」 and 「解答用紙 3 : 街区 2 の開発計画 (図面) (Answer Sheet 3 : Development Plan for Block 2 (Map))」, propose a development plan for Block 2, which includes the following items, with a 1/1000 map and texts. If necessary, you may illustrate diagrams and sketches with the texts.

- (1) Collective housing (form of housing buildings, location of entrances, number of floors, number of units for each housing type)
- (2) Car parking lots
- (3) Spaces for bicycle parking, garbage collection and others necessary facilities for a collective housing area
- (4) Neighborhood park
- (5) Playgrounds for infants and elementary school children
- (6) Paths within the block (for automobiles, bicycles and pedestrians)
- (7) Green space and open space
- (8) Vegetation (trees, shrubs, lawns, etc.)

End of the document



図1 地区X及びその周辺の状況
 Figure 1 Condition of Site X and its Surroundings

解答用紙 1 : 地区Xの開発構想 (図面)
Answer Sheet 1: Development Concept for Site X (Map)

受験番号
Examination I. D.

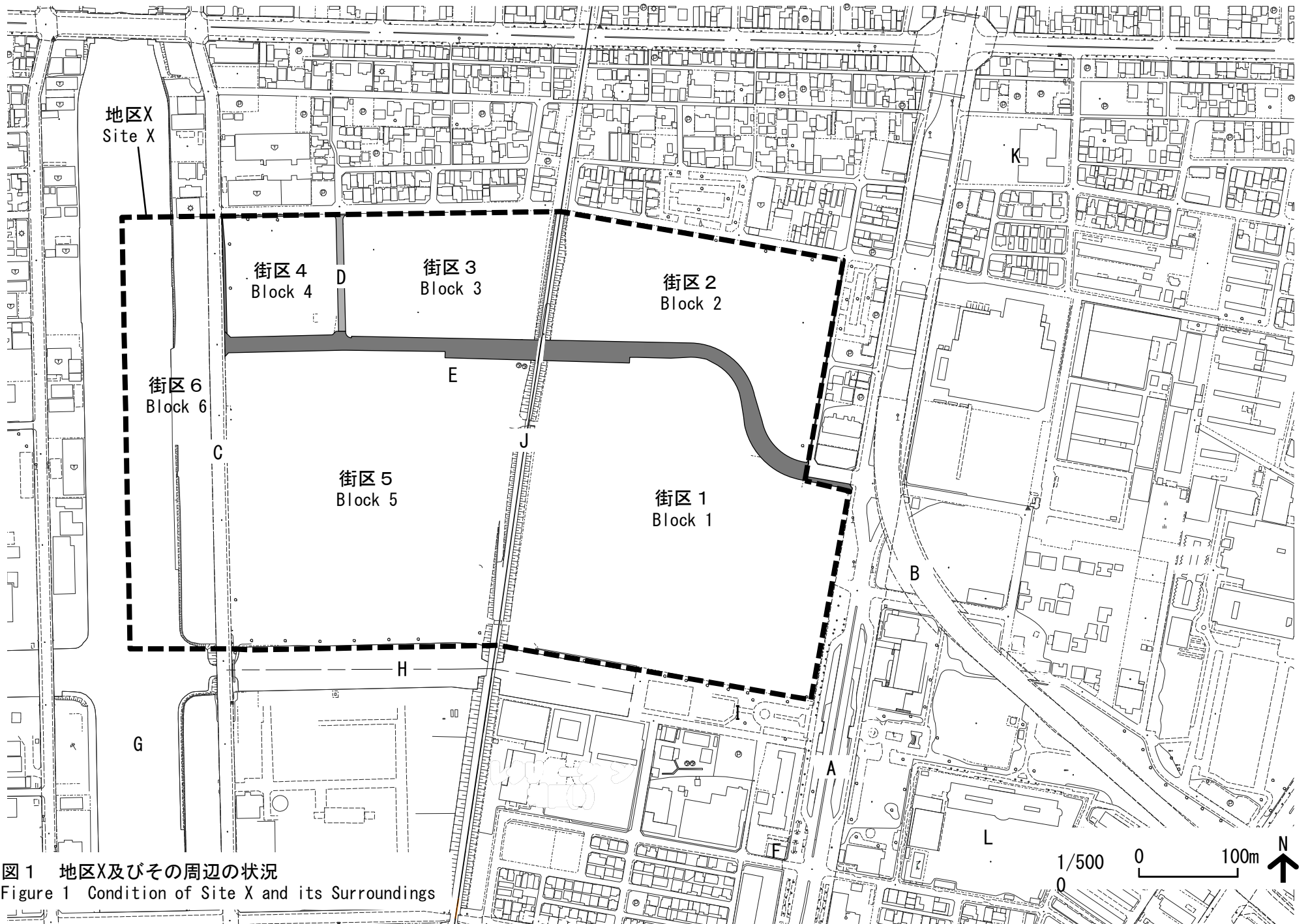
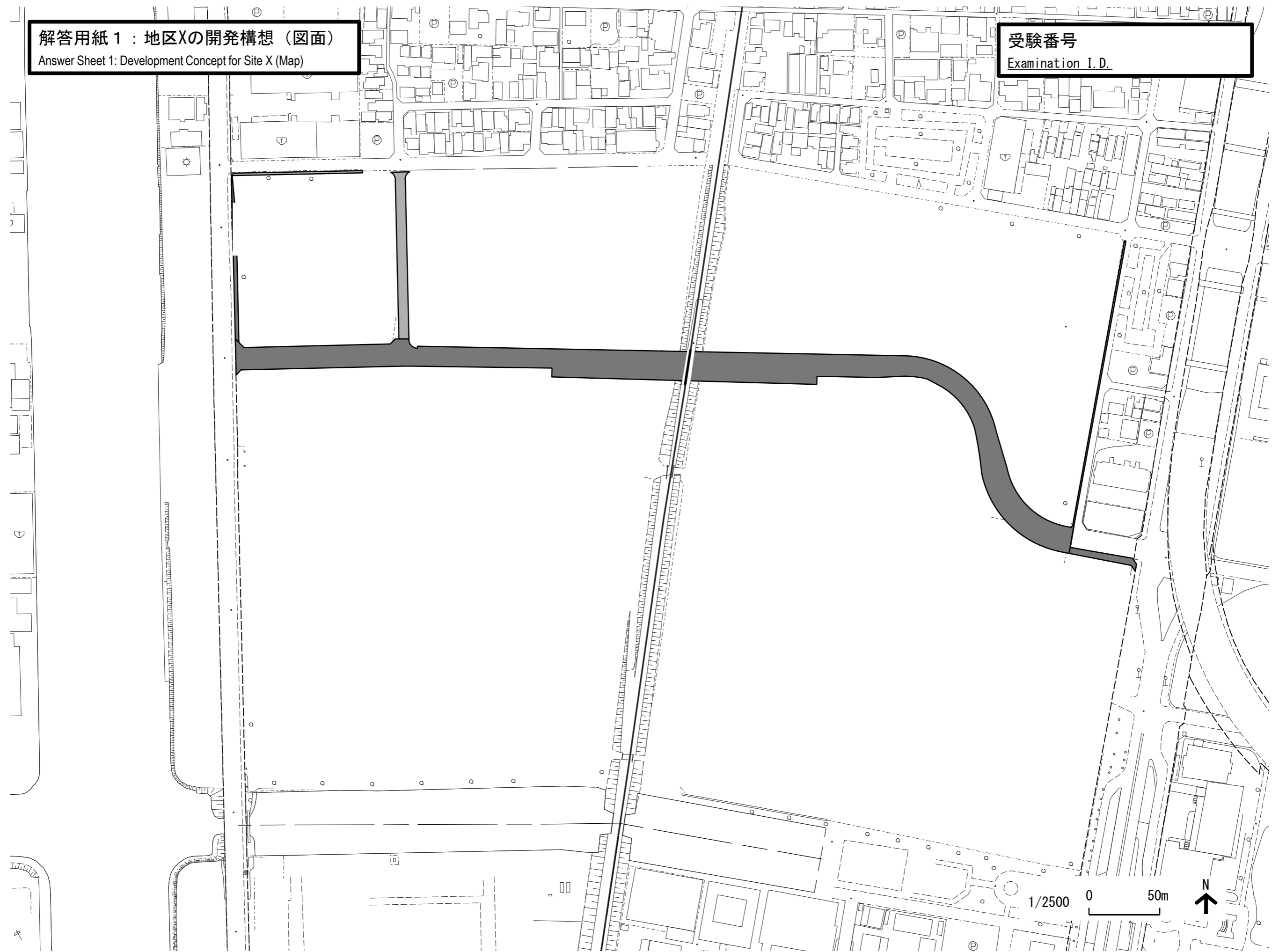

解答用紙 2 : 地区Xの開発構想・街区 2 の開発計画 (文章)

Answer Sheet 2: Development Concept for Site X and Development Plan for Block 2 (Texts)

受験番号

Examination I.D.

地区Xの開発構想 (Development Concept for Site X)

街区 2 の開発計画 (Development Plan for Block 2)

受験番号
Examination I.D.

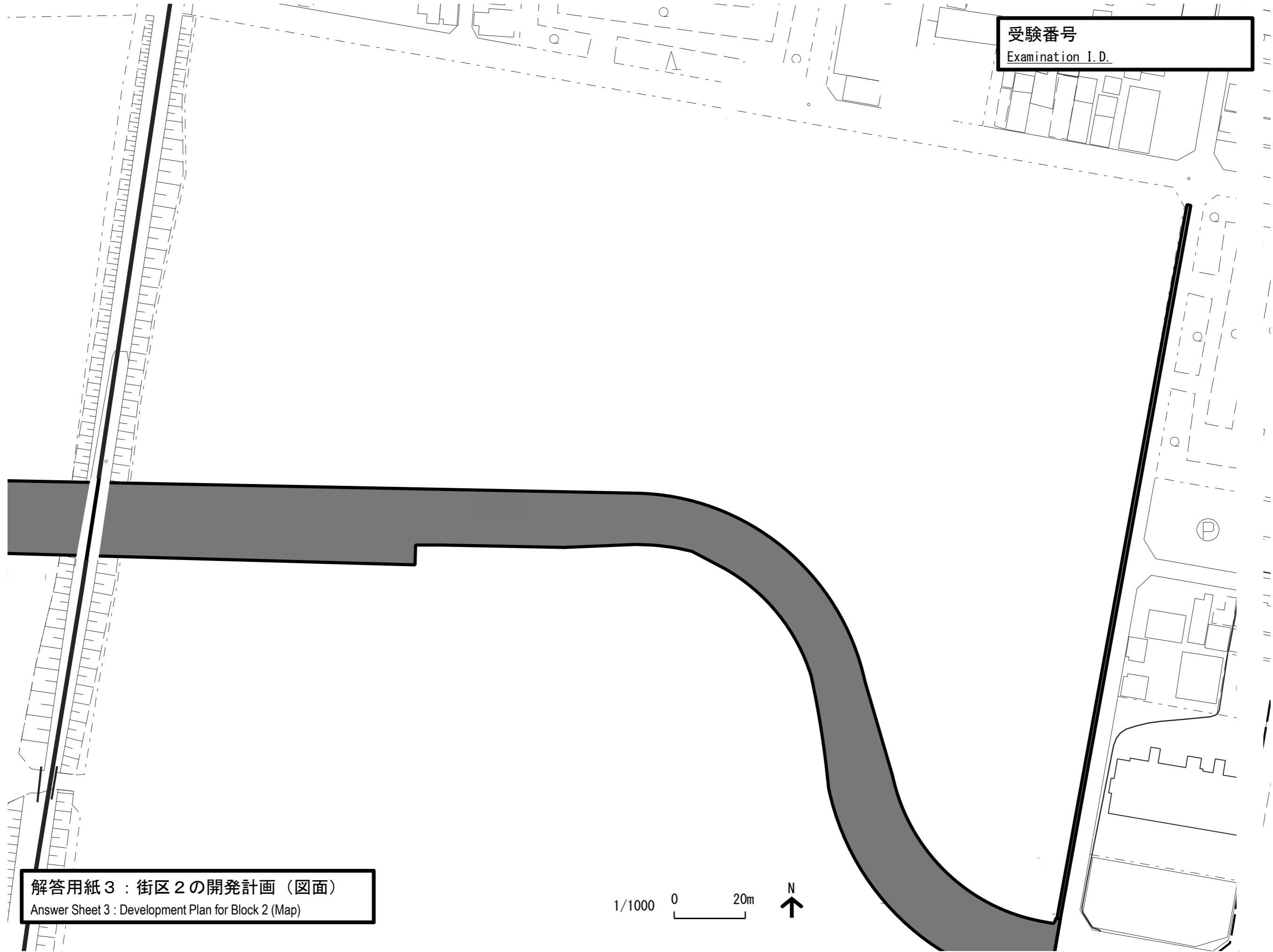

解答用紙 3 : 街区 2 の開発計画 (図面)
Answer Sheet 3 : Development Plan for Block 2 (Map)

1/1000 0 20m N ↑

2017年8月28日 13時～16時
13:00-16:00, August 28, 2017

[C 計画・設計・論文]
[C Planning/Design/Essay]

C-4 論文
(専攻分野：都市計画)
C-4 Essay
(Major Field of Study: Urban Planning)

受験番号

Examination I. D.

- (1) すべての答案用紙の所定の欄に、問題番号、受験番号を記入しなさい。氏名を記入してはならない。
Write the question number and your examination I. D. on all the answer sheets. Do not write your name.
- (2) 問題冊子に受験番号を記入しなさい。
Write your examination I. D. on this sheet.
- (3) 専攻分野として「都市計画」を希望するものは、C-3、C-4のいずれか1科目を解答しなさい。
If your major field of study is “Urban Planning,” then answer either C-3 or C-4.

C-4 Essay

In Japan, the decline of the country-side is an important policy issue. Discuss how the country-side can be revitalized by paying attention to the following points:

- (1) Polarization to Tokyo, decrease of population and globalization are often pointed out as the fundamental causes of decline of the country-side. How do those three causes bring about the decline of the country-side?
- (2) Above-mentioned three causes are mutually inter-related and work as structural causes. How are these three causes interrelated? Use (a) diagram(s) to explain it.
- (3) Itemize three possible policy measures for the revitalization of the country-side, and state their contents.
- (4) How do those three possible policy measures work towards the structural causes mentioned in (2), and what effects can they generate? What are the limitations and challenges with regard to the implementation of those three possible policy measures?

End of the document